

User manual Monitor

# Vario II



# Table of Contents

General specifications of monitor .....	3
<b>Main menu .....</b>	<b>4</b>
- Setup of meter counter .....	4
- Wheel steering.....	5
- system info .....	5
- - Tiger.....	6
- - - Error menu .....	6
- Counters .....	7
- Setup.....	7
- - Setup .....	8
- Vacuum 1.....	8
- - Vacuum 2.....	9
- Suction .....	9
- Spades .....	10
- Drift pin 1 .....	10
- - Drift pin 2.....	11
- Extra.....	11
<b>Main menu (Screen mounted on trailer) .....</b>	<b>12</b>
- Meter counter .....	12
- - Meter counter .....	13
- Vacuum 1.....	13
- - Vacuum 2.....	14
- Suction .....	14
- Spades.....	15
- Error menu.....	15
- Use of remote control .....	16
- Use of remote control .....	16
Instruction in Calibration of wheel steering.....	17
Straight calibration.....	17
Calibration of extremities .....	17
<b>Gøma Support .....</b>	<b>18</b>

**General specifications of monitor**

Display:	800 x 480 pixels.
Brand:	Bosch Rexroth
Model:	D14-M-PRO
Dimensions:	267.2mm x 135.9mm x 65mm
Screen sizes:	7" (17.8 CM)
Plug:	(Tyco AMP 1437288-6) 26 pole plug
Montagehuller:	3 pcs M5
Operation:	Touch + Buttons



The pressure equalization element needs mechanic protection

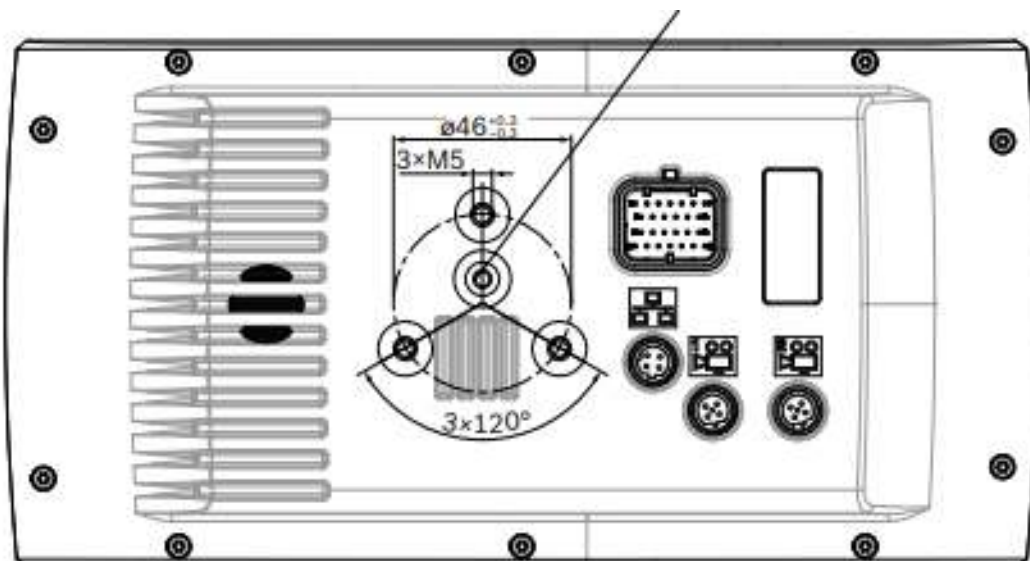

Main menu

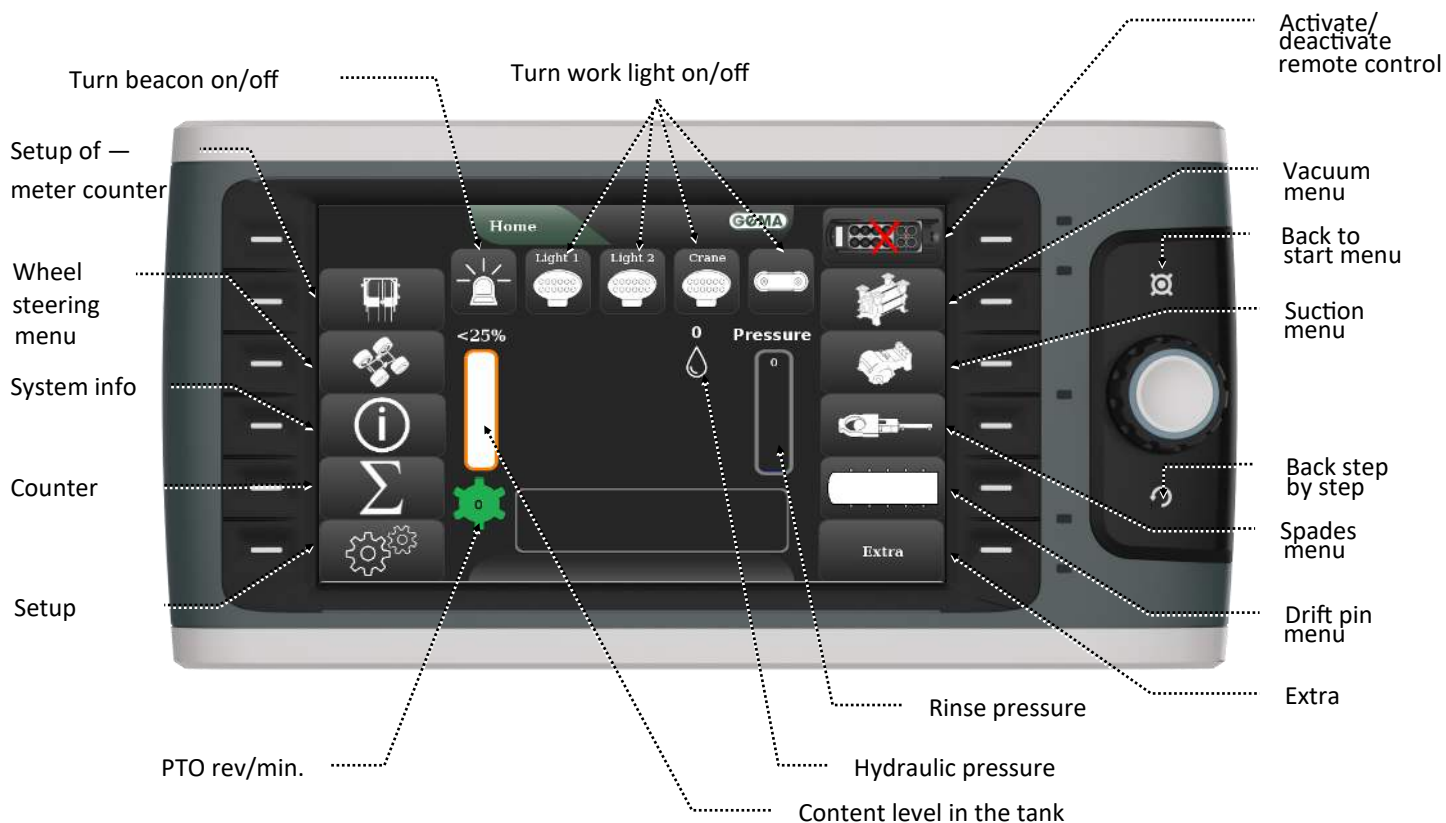

Main menu—Setup of meter counter

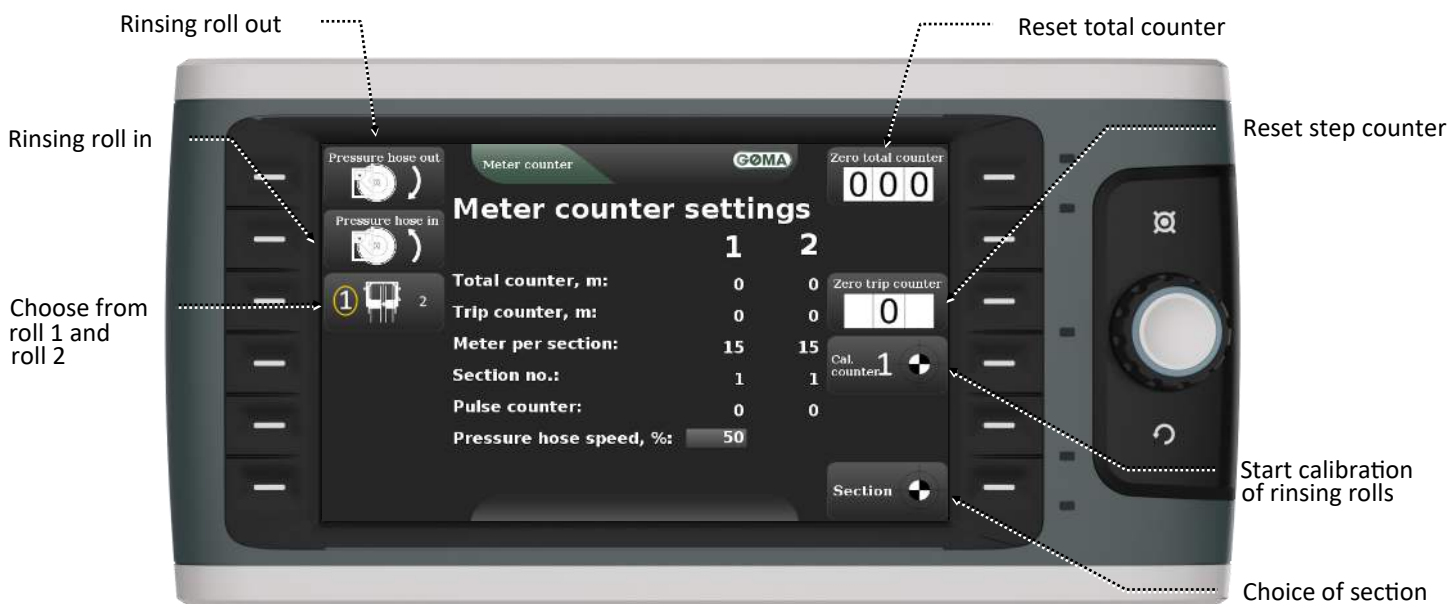

Main menu — Wheel steering



Wheel steer	
Master sensor value:	10.0 mA
Master sensor value from center:	25 %
Boogie sensor value:	10.1 mA
Boogie sensor value from center:	24 %
Boogie/master deviation:	-0 %
Boogie left max:	20.0 mA
Boogie right max:	4.0 mA
Wheel steer regulation:	0
Speed wheel lock:	35 km/h
High speed wheel steer:	20 km/h

Navigation options on the right:

- Straight Calibration
- Calibration of extremities
- Auto steering
- Forced steering
- Forced steering

Main menu — System info.



Navigation options on the right:

- Error menu
- Setup of remote control

Main menu — System Info— Tiger



Button for switching between active layers

Explanation of button feature

Buttons for coding of remote control

Buttons for coding of remote control

Button of how many layers should be active

Button for coding of remote control

Main menu — system info—Error menu



Reset

Change: Saved errors

Delete error

Switch between active and saved errors

Main menu — Counters



Main menu — Setup



Start/stop PTO



Main menu — Setup 1:2 — Setup 2:2

Resets the remote control settings back to factory settings

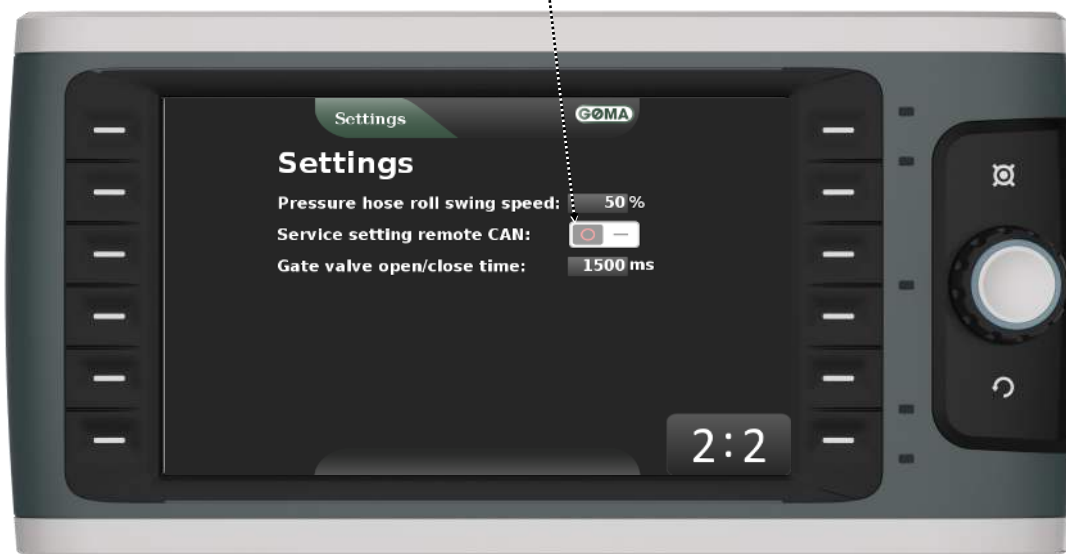

Main menu — Vacuum 1



Turn beacon on/off

Turn work light on/off

Roll out

Roll in

Crane down

Crane up

Crane out

Crane in

Rotate jib

Rotate jib

PTO rev/min.

Content level in tank

Rinse pressure

Hydraulic pressure

Start/stop Vacuum pump

Chosen spade from spade menu. Open and close spade/filter

Choice between pressure and suction



Main menu — Vacuum 1:2—Vacuum 2:2

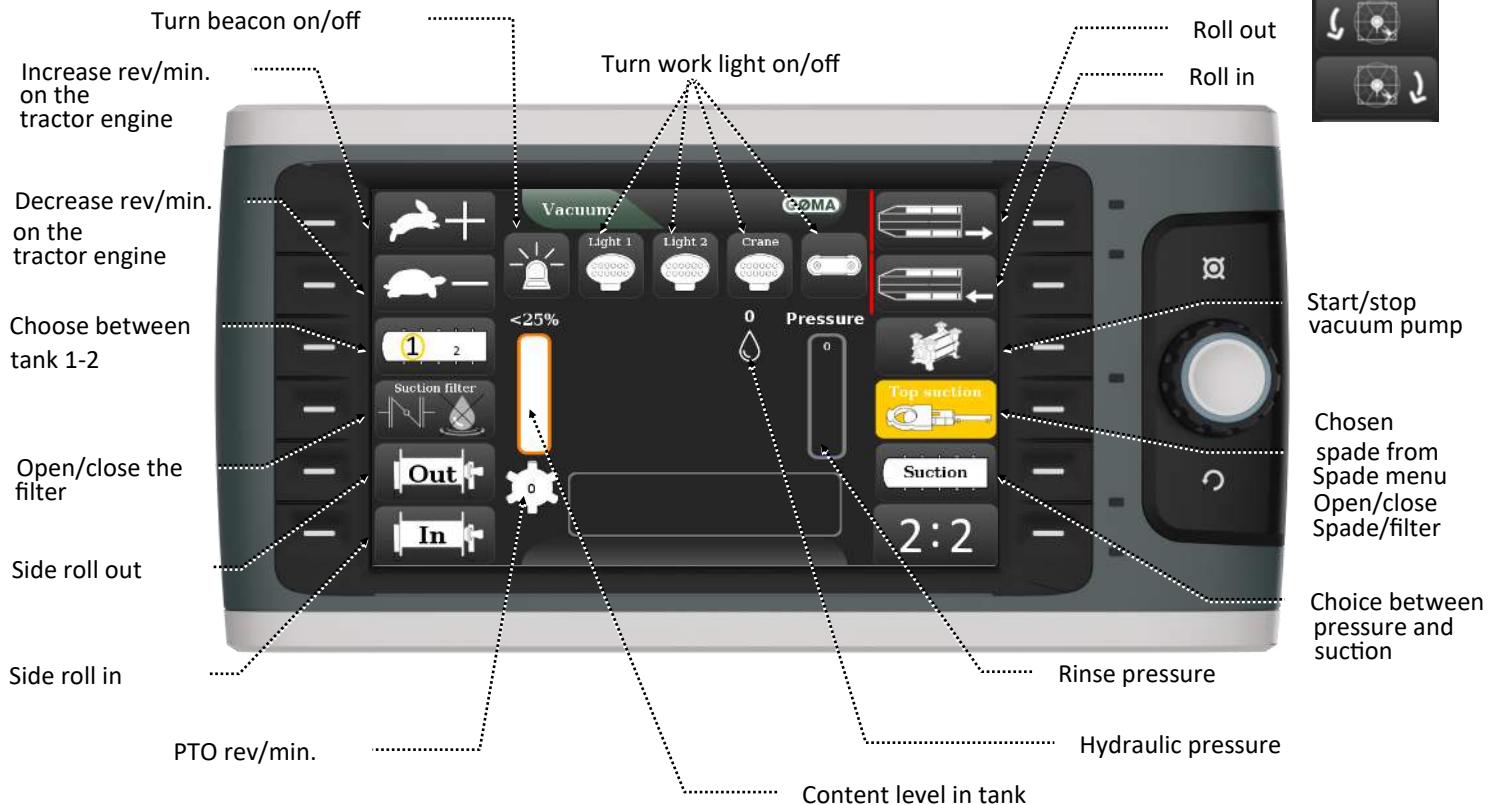

Main menu — Suction

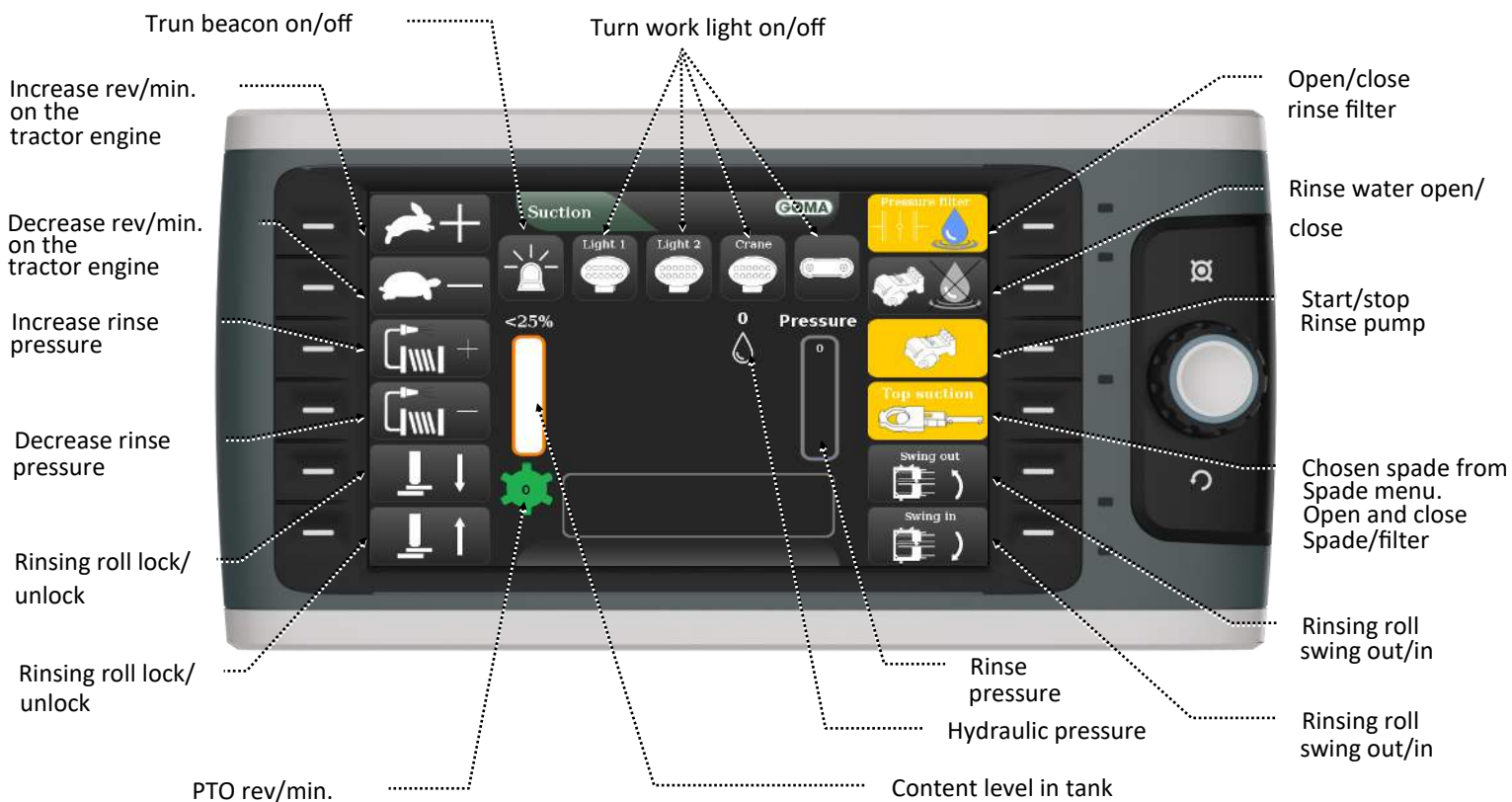

Main menu — Spades



Turn beacon on/off

Turn work light on/off

Open/close spades/filter  
(Number of spade valves might be less than the displayed image)

Open/close spades  
(The number of spade valves might be less than the displayed image)

Choice of spade/filter to be active in the vacuum and suction menu

Rinse pressure

Hydraulic pressure

Closure of all spades

Content level in tank

PTO rev/min.

Labels on panel: V. roll 3", V. roll 4", Water suction, Side roll, Tower, Suction filter, Gate valve, Light 1, Light 2, Crane, GOMA, Top suction, Bottom suction, Back 4", Back 6", Close valves, Pressure, <25%, 0

Main menu — Drift pin 1



Choice of the partition's position

Choice between high and low pressure

Start/stop vacuum pump

Choice between tank 1-2

Choice between pressure and suction

Position of the partition

Labels on panel: Dorn, GOMA, Air pod pressure high, Dorn number: 1 2 3 4 5, Separation wall section: 1 2 3 4 5 6, Pressure, 1:2

Main menu — Drift pin 1:2 — Drift pin 2:2



Increase rev/min.  
on the  
tractor engine

Decrease rev/min.  
on the  
tractor engine

Open tailgate

Close tailgate

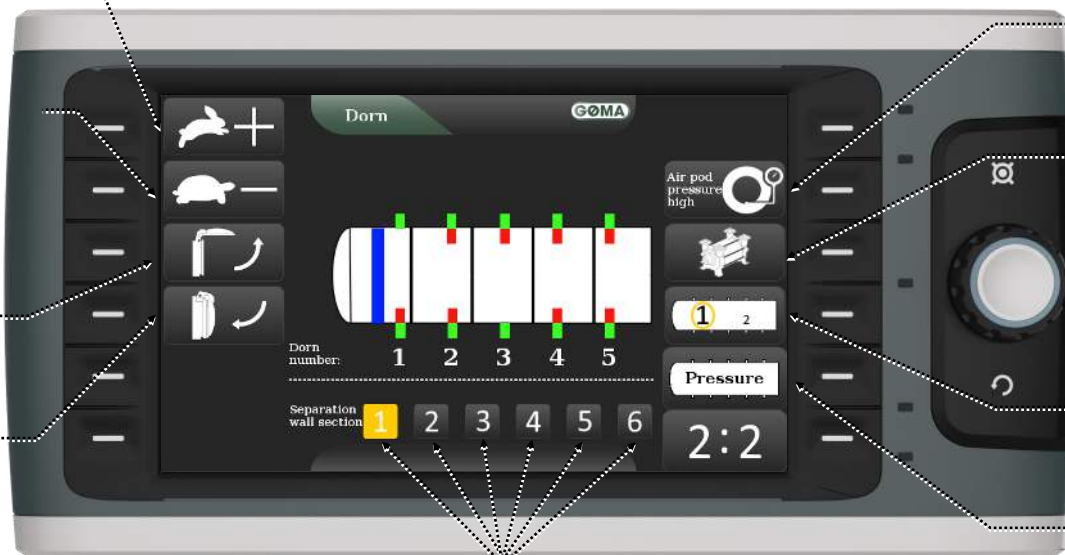

Choice between  
high and low  
pressure

Start/stop  
vacuum pump

Choose tank 1/2

Choice between  
pressure and suction

Position of the partition

Main menu — Ekstra



Turn beacon on/off

Turn work light on/off

Frost circulation

Heating in electric  
cabinets

Light in electric  
cabinets

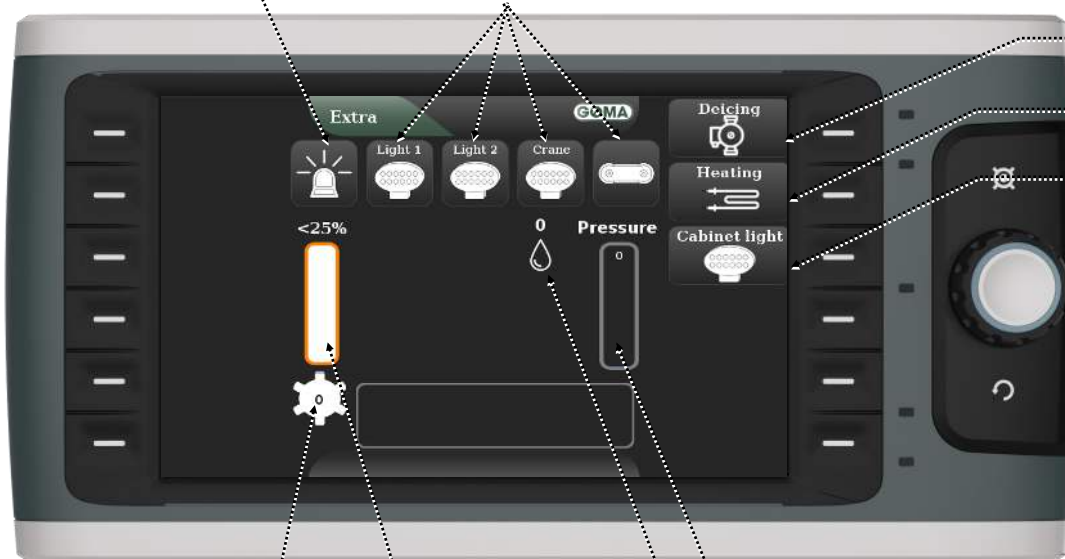

PTO rev/min.

Rinse pressure

Hydraulic pressure

Content level in tank

Main menu.

Screen mounted on trailer.

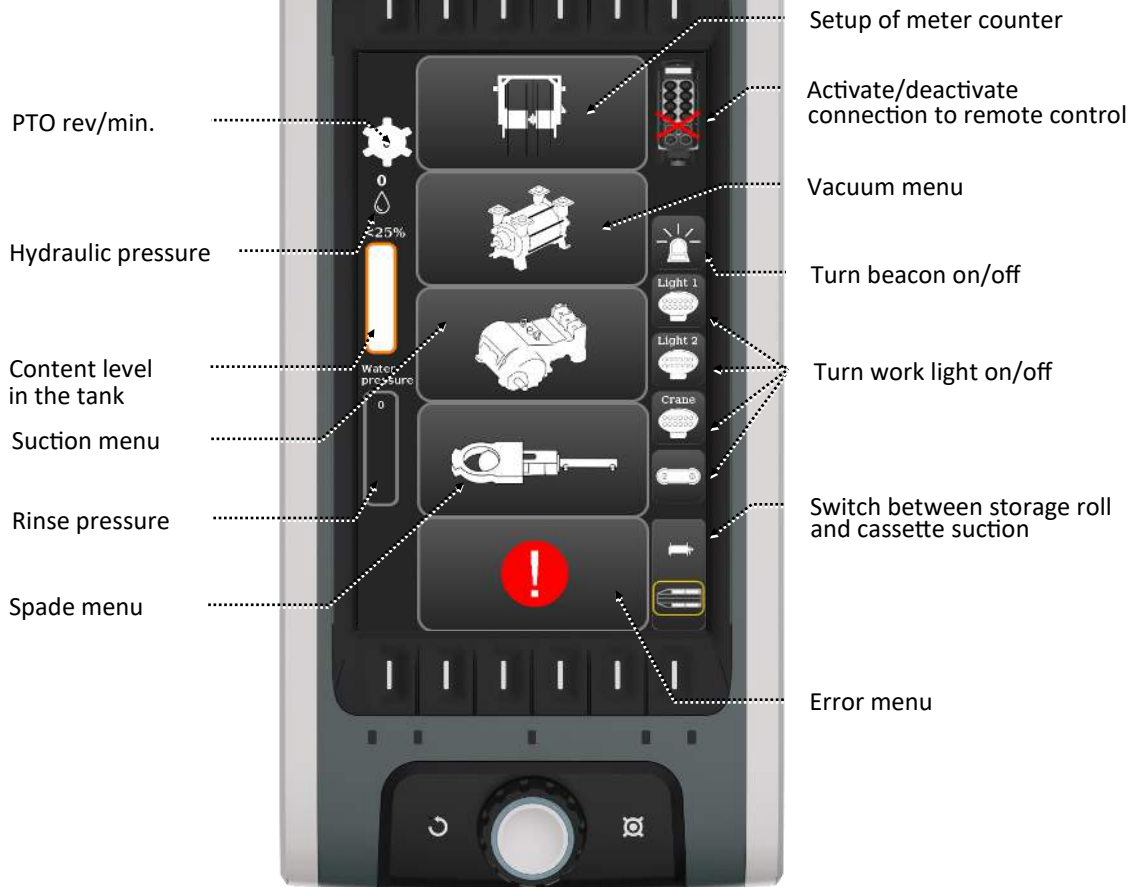

Main menu — Meter counter

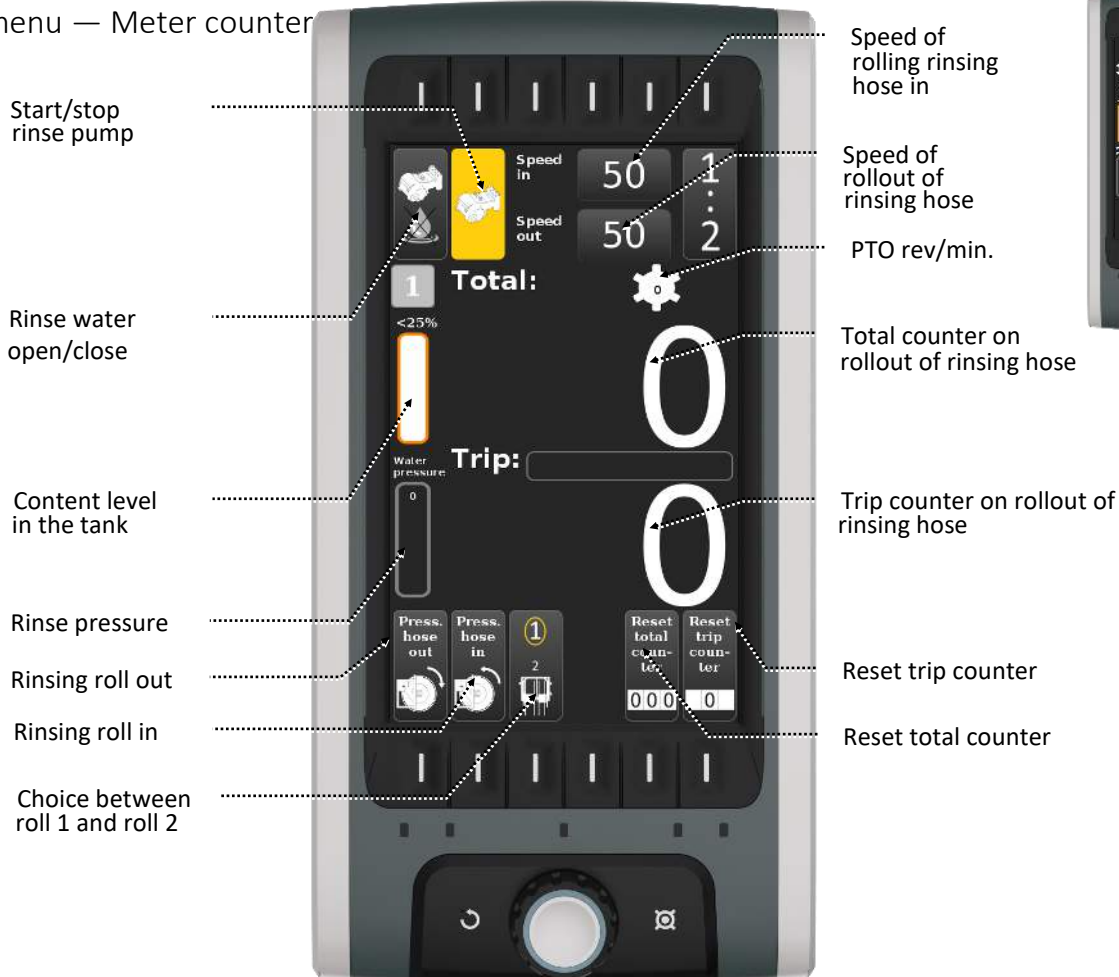

Main menu — Meter counter

1:2 — Meter counter 2:2

Speed of rolling rinsing hose in: 50 2

Speed of rollout of rinsing hose: 50 2

PTO rev./min. (gear icon)

Total counter on rollout of rinsing hose: 0

Meter/section: 1 2  
15 15

Section no.: 1 1

Pulse counter: 0 0

Choice between roll 1 og roll 2 (1/2 buttons)

Rinsing roll swinging out/in (Swing out/in buttons)

Rinsing roll swinging out/in (bottom buttons)

Reset total counter (Reset total counter button)

Choice of section (section buttons)

Start calibration of rinsing roll (Cal. counter button)



Main menu — Vacuum 1

Hydraulic pressure (<25% gauge)

Content level in the tank (vertical bar)

Rinsing pressure (0 gauge)

Start/stop vacuum pump (In/Out buttons)

Roll out (roll out icon)

Roll in (roll in icon)

Crane up/down/in/out, Yaw in/out

Rev./min. (gear icon)

Turn beacon on/off (beacon icon)

Turn work light on/off (Light 1/2 icons)

Chosen spade from spade menu. Open and close spade/filter (spade icons)

Choose between pressure and suction (Top suction/Pressure buttons)



Main menu — Vacuum1:2 -

Vacuum 2:2

Choose tank1/2

Decrease rev/min. on the tractor engine

Increase rev/min. on the tractor engine

Hydraulic pressure

Content level in the tank

Rinse pressure

Start/stop vacuum pump

Roll out

Roll in

Open/close filter

Side roll out

Side roll in

PTO rev/min.

Turn beacon on/off

Turn work light on/off

Chosen spade from spade menu. Open and close spade/filter

Choose between pressure and suction

Inset images: Roll out (arrow pointing right), Roll in (arrow pointing left)

Main menu — Suction

Increase rinse pressure

Decrease rinse pressure

Decrease rev/min. on the tractor engine

Increase rev/min. on the tractor engine

Hydraulic pressure

Content level in the tank

Rinse pressure

Start/stop rinse pump

Open/close the filter

Rinse water open/close

Decrease rinse pressure

Rinsing roll lock/unlock

Rinsing roll lock/unlock

PTO rev/min

Turn beacon on/off

Turn work light on/off

Chosen spade from spade menu. Open and close spade/filter

Rinsing roll swinging out/in

Rinsing roll swinging out/in

Inset image: Rinsing roll lock/unlock (yellow circle around the icon)

Main menu—Spades

Open/close spade/filter

Hydraulic pressure

Content level in tank

Rinse pressure

Open/close spade/filter

Open/close spade/filter

PTO rev/min.

Turn beacon on/off

Turn work light on/off

Closure of all spades

Choice of spade/filter to be active in the vacuum and suction menu

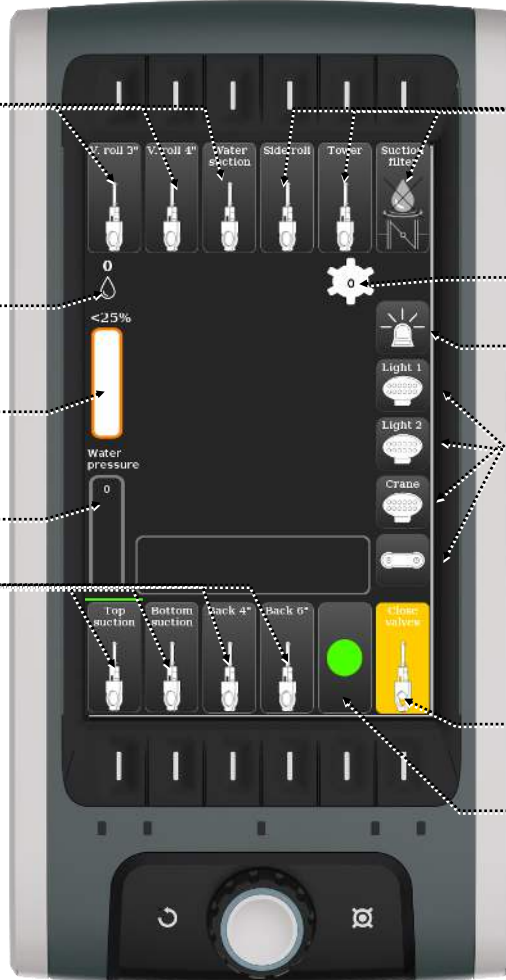

Main menu — Error menu

View active errors

Delete error

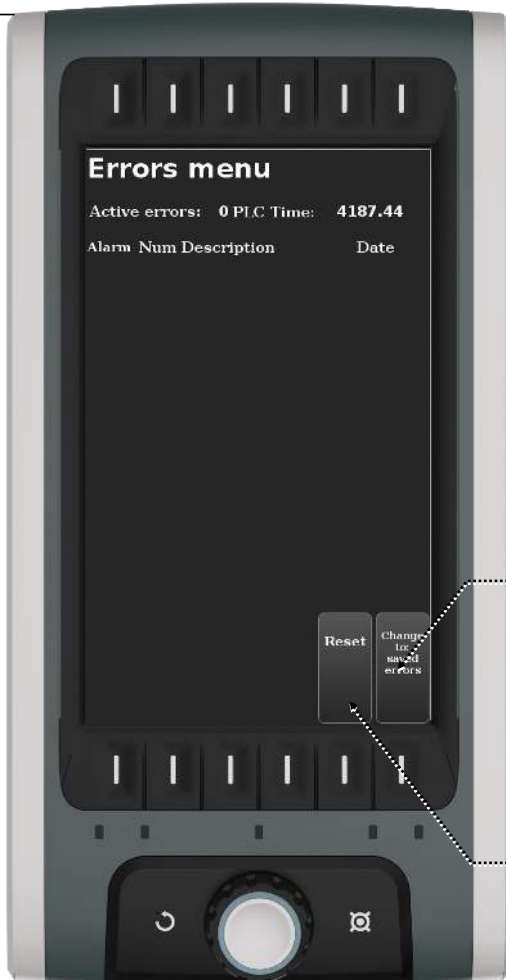

Use of remote control

Buttons for using misc. features. The buttons' features are chosen in system info on monitor. All the buttons have proportional function

Buttons for usgin misc. features. The buttons' features are chosen in system info on monitor. No proportional function. Button 11 and 12 are held down at start up as described in display

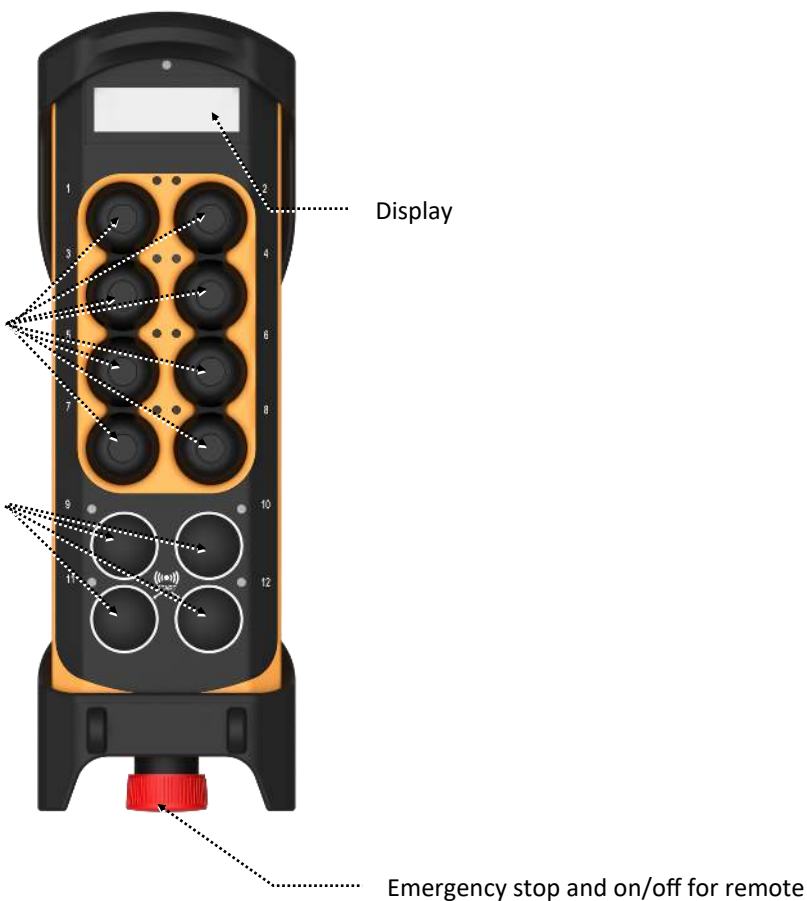

Use of remote control

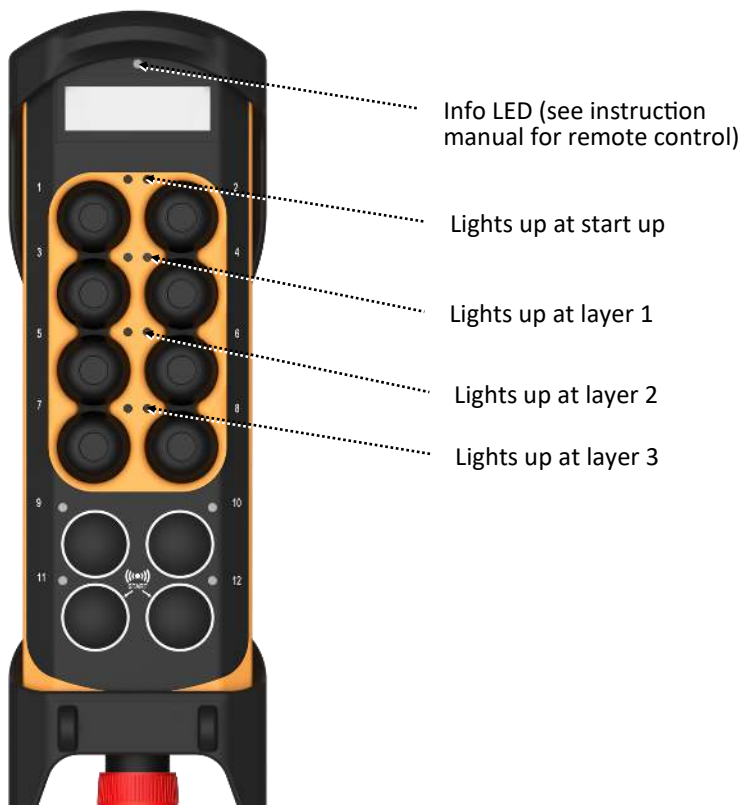



# Instructions

## Calibration of wheel steering:

Calibrations of the wheels on the trailer should be made approx. once a month or if the trailer has been detached from the tractor.

### Straight Calibration.

Press  A box will appear on the screen saying: start Straight calibration. You should press the green checkmark. The button for straight calibration will light up yellow. The button called Auto, Coasting, Manual, will automatically go to coasting. Drive forward till the tractor and the trailer are straight. Press Straight calibration so it's no longer yellow. Straight calibration is completed.



### Calibration of extremities.

Press A  box will appear on the screen saying: start Calibration of extremities. You should press the green checkmark. The button for calibration of extremities will light up yellow. The button called Auto, Coasting, Manual, will automatically go to manual.

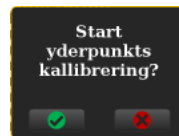

Then press the button turn  wheel to the left. Press it until the wheels cannot be turned anymore.

Then press the  button rotate wheel to the right. Press it until the wheels cannot be turned anymore.

Lastly, you should press the button calibration of extremities, so it no longer lights up in yellow. The auto, coasting, manual button will automatically go to auto. The calibration of extremities has now been completed.



+45 86 61 07 77



[viborg@goma.dk](mailto:viborg@goma.dk)



See opening hours at [www.goma.dk](http://www.goma.dk)

