

# Krantårn

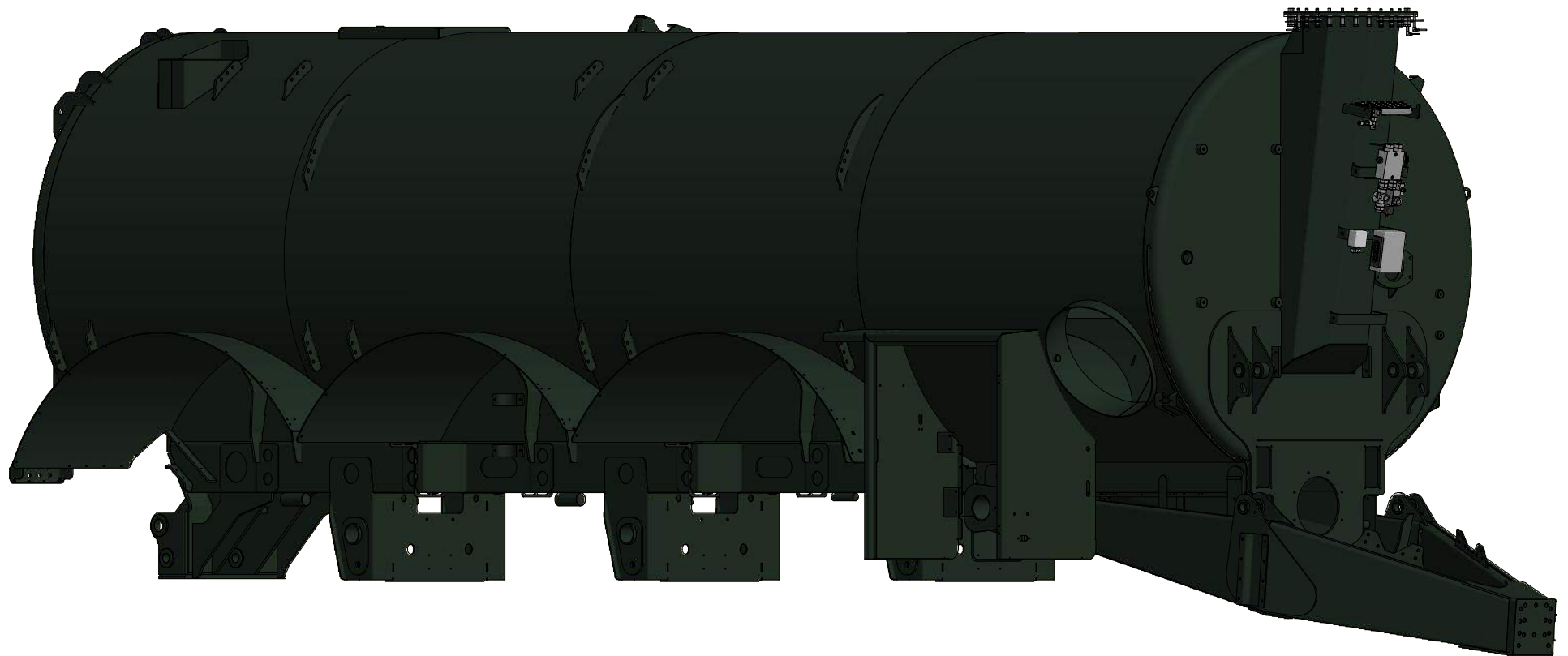

| GØMA PARTS LIST |     |                                   |            | GØMA PARTS LIST |     |  |            |
|-----------------|-----|-----------------------------------|------------|-----------------|-----|--|------------|
| ITEM            | QTY | DESCRIPTION                       | Order no.  | ITEM            | QTY | DESCRIPTION                                    | Order no.  |
| 1               | 2   | Stålsætbolte, 6X20MM              | 0057620    | 29              | 2   | Beslag aftaster side krøjekrans                | G40000999  |
| 2               | 4   | Stålsætbolte, 8X25MM              | 0057825    | 30              | 1   | Beslag aftaster midt krøjekrans                | G400001000 |
| 3               | 2   | Unbrakobolt 10.9 M10x1,5 x 70     | 00841070   | 31              | 1   | Elkasse til autoparkering af kran for GG vogne | G420000130 |
| 4               | 2   | Låsemøtrik, M10MM                 | 036810     | 32              | 1   | Elkasse til flowmåler for GG vogne             | G420000148 |
| 5               | 2   | Låsemøtrik, M6MM                  | 03686      | 33              | 1   | Triangel svejst                                | G430000004 |
| 6               | 4   | Låsemøtrik, M8MM                  | 03688      | 34              | 1   | Tank GG-25                                     | G440000001 |
| 7               | 2   | Facetskive, M10MM                 | 040710     | 35              | 1   | Montageplade f/hydraulikslanger f/krantårn     | G440000395 |
| 8               | 4   | Facetskive, M6MM                  | 04076      | 36              | 18  | Spændebøsning pumpetårn GG kort                | G440000401 |
| 9               | 8   | Facetskive, M8MM                  | 04078      | 37              | 19  | Spændebøsning pumpetårn GG lang el galv.       | G440000402 |
| 10              | 1   | Skærmskive, FZ 10,5X30X3MM M10    | 041110303  | 38              | 3   | Ledning M/Stik Vinkel 5 Mtr.                   | G800000065 |
| 11              | 1   | Lige Samler, Let 28MM             | 0977660    | 39              | 3   | Inductiv Føler 12MM Uskærmet.                  | G800000074 |
| 12              | 1   | Vinkelforskruning, Ew-10L -A3c    | 1152073    | 40              | 1   | Hyd blok LS læssekran                          | G840000009 |
| 13              | 1   | Vinkelforskruning, Ew-22L -A3c    | 1152628    | 41              | 12  | Lige skotforskruning 10                        | G840000041 |
| 14              | 1   | Omvendt samler ø15L               | 1187889    | 42              | 1   | Patronventil Magnetst. LS Tårn                 | G840000136 |
| 15              | 1   | Reduktionsforskruning.15/10-L     | 1197029    | 43              | 1   | Hydraulik blok, LS læssekran GG vogne          | G840000188 |
| 16              | 1   | Reduktion ø28L indv x ø22L udv    | 1223379    | 44              | 1   | T-Stykke, EI-15- A3c                           | G840000215 |
| 17              | 1   | T-Stykke,Justerbar L-stykke Ø28 L | 4438271853 | 45              | 28  | Stålbolt, 12X80MM, 10.9                        | G880000112 |
| 18              | 2   | Lige skotforskruning 6mm Svær     | 4438273037 | 46              | 1   | Indskruning Ø10-1/4" M/Oringst                 | VA10RLDKO  |
| 19              | 1   | Forskruning, L10MMX1/4"           | 606        | 47              | 1   | Vekselventil G1/4"                             | VA14       |
| 20              | 2   | Forskruning, L12MMX1/4"           | 609        | 48              | 4   | Indskruning ø28L indv x 1 BSP udv.             | VA28RLDKO  |
| 21              | 1   | Forskruning, L22MMX3/4"           | 619        |                 |     |  |            |
| 22              | 1   | Samler, L15XL15MM                 | 695        |                 |     |  |            |
| 23              | 2   | Skotforskruning, L12MM            | 733        |                 |     |  |            |
| 24              | 1   | Skotforskruning, L15MM            | 734        |                 |     |  |            |
| 25              | 2   | Indskruning Ø28-3/4"              | 763656     |                 |     |  |            |
| 26              | 1   | Testnippel M16                    | 938000854  |                 |     |  |            |
| 27              | 1   | Magnetspole, 12VDC 1/2" 14W       | CCS012D    |                 |     |  |            |
| 28              | 1   | Spændeplade f. GG kran, RF        | G400000763 |                 |     |  |            |

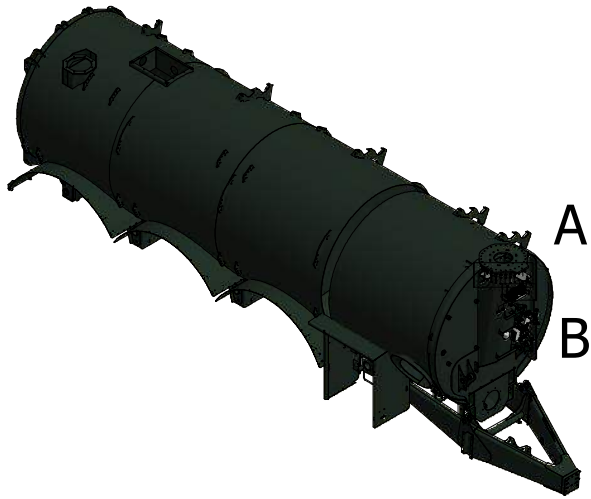

A ( 1 : 7 )

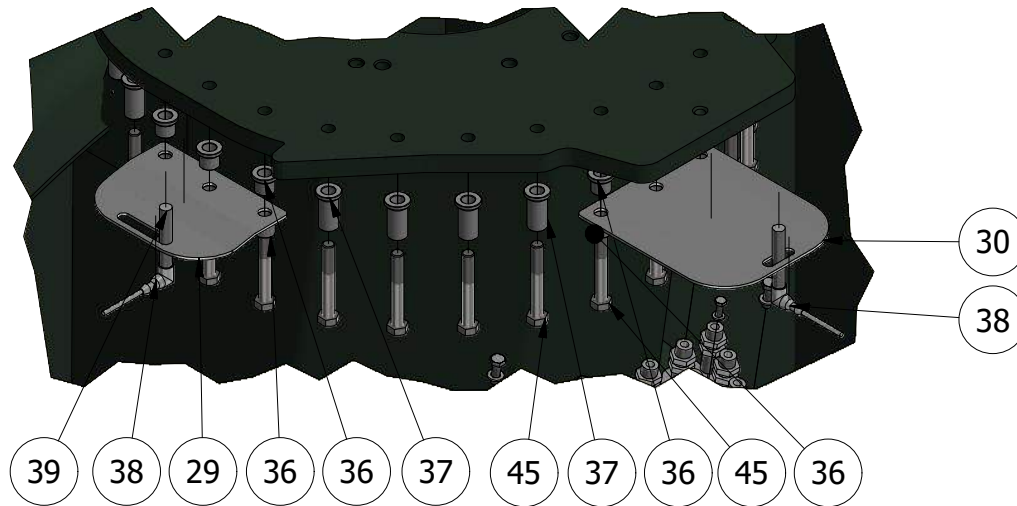

B ( 1 : 5 )

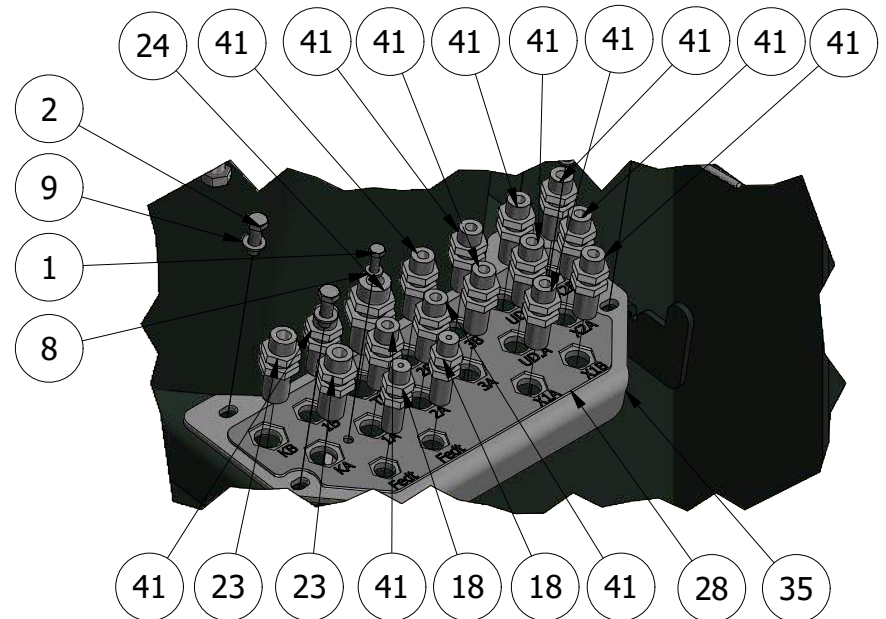

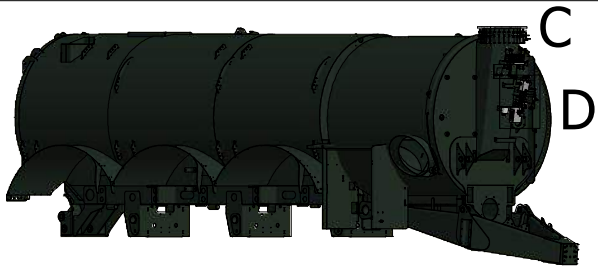

D (1:7)

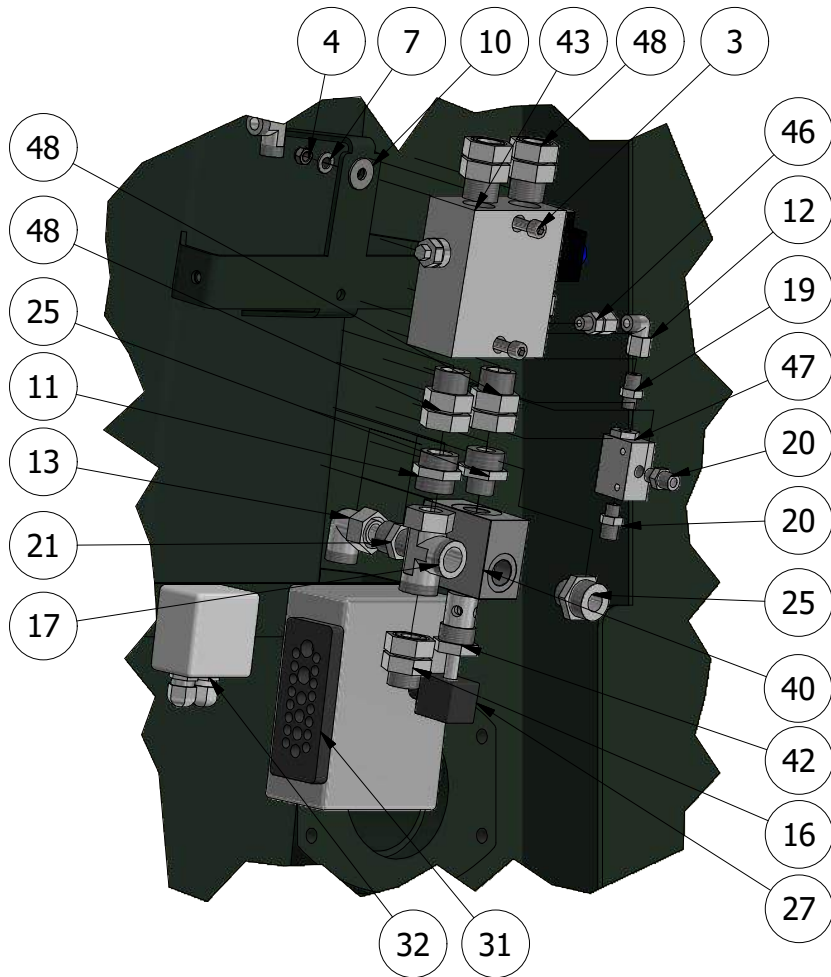

C (1:5)

